

# MODERN MGP PATIO TABLE

KCF2416  
REV. 1  
11/13/24

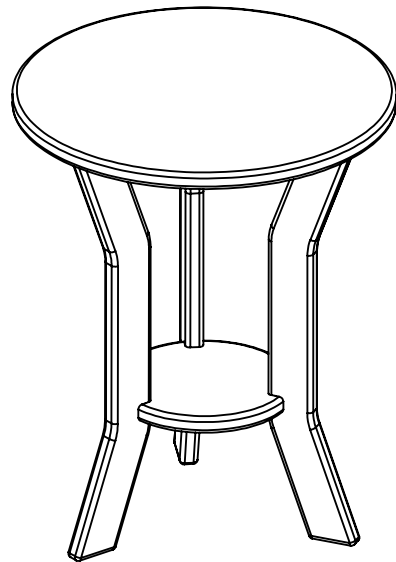

# MODERN MGP PATIO TABLE

TABLE TOP  
QTY. = 1

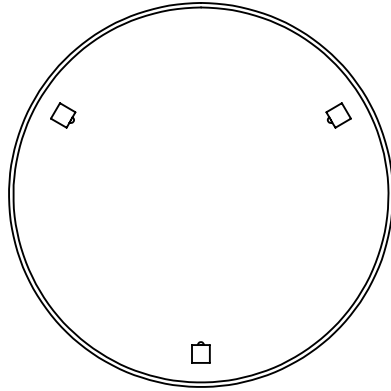

LEG  
QTY. = 3

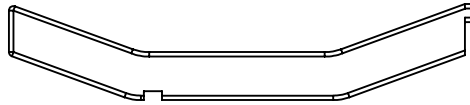

SHELF  
QTY. = 1

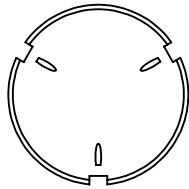

#8 X 1-5/8" SCREWS  
QTY. = 6

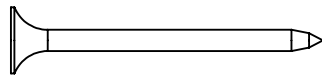

**COMPONENTS  
REQUIRED FOR  
ASSEMBLY**

**1/2**

# MODERN MGP PATIO TABLE

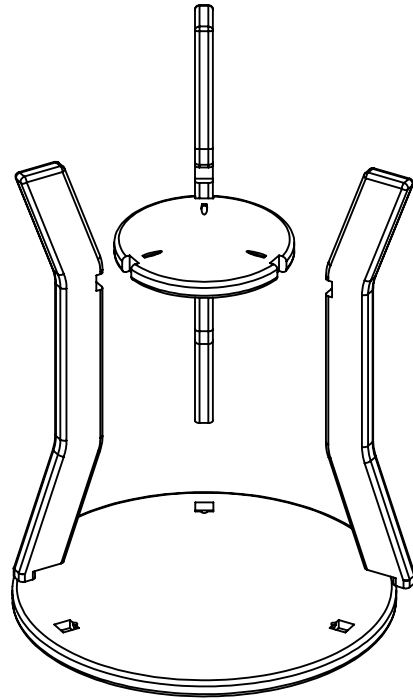

STEP 1: PLACE TOP ON A CLEAN, SMOOTH SURFACE, UPSIDE DOWN.

STEP 2: INSERT ALL 3 LEGS INTO THE SQUARE CUTOUTS AS SHOWN. MAKE SURE THEY ARE INSERTED ALL THE WAY IN.

STEP 3: SECURE ALL 3 LEGS USING A #8 SCREW, MAKING SURE TO HOLD THE LEGS DOWN FIRMLY TO THE TOP. SOMETIMES IT MAY BE NECESSARY TO BACK THE SCREW OUT AND DRIVE IT BACK IN TO GET A TIGHT FIT.

STEP 4: LINE UP THE NOTCHES IN THE SHELF WITH THE LEGS, AND PRESS IT INTO PLACE SO THE NOTCHES INTERLOCK.

STEP 5: INSERT A #8 SCREW IN EACH POCKET HOLE LOCATION. START THE SCREW, THEN GRAB THE BACK SIDE OF EACH LEG AS YOU DRIVE THE SCREW IN TO GET A TIGHT FIT. AGAIN, IT MAY BE NECESSARY TO BACK THE SCREW OUT AND DRIVE IT BACK IN TO GET A TIGHTER FIT.

## REQUIRED TOOLS (NOT INCLUDED)

1 - SCREW GUN

1 - #2 SQUARE DRIVE BIT

# MODERN MGP PATIO TABLE

KCF2416  
REV #1  
11/13/24

ALL DIMENSIONS ARE SHOWN IN INCHES

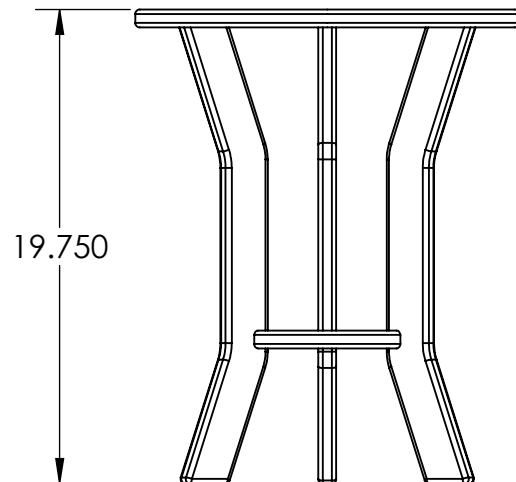

**FRONT**

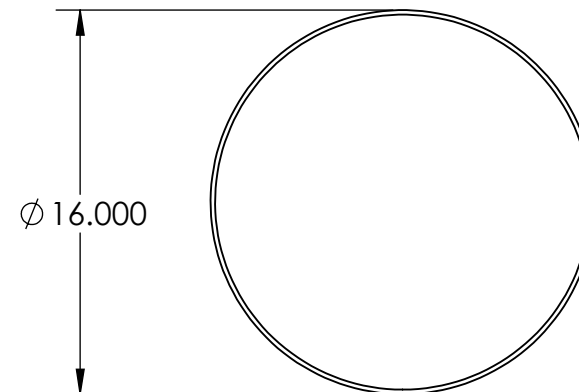

**TOP**

NOTE: ALL MATERIAL IS RECYCLED PLASTIC LUMBER UNLESS NOTED