

TABLE INSTRUCTIONS

CF1145 REV# 3
9-12-2022

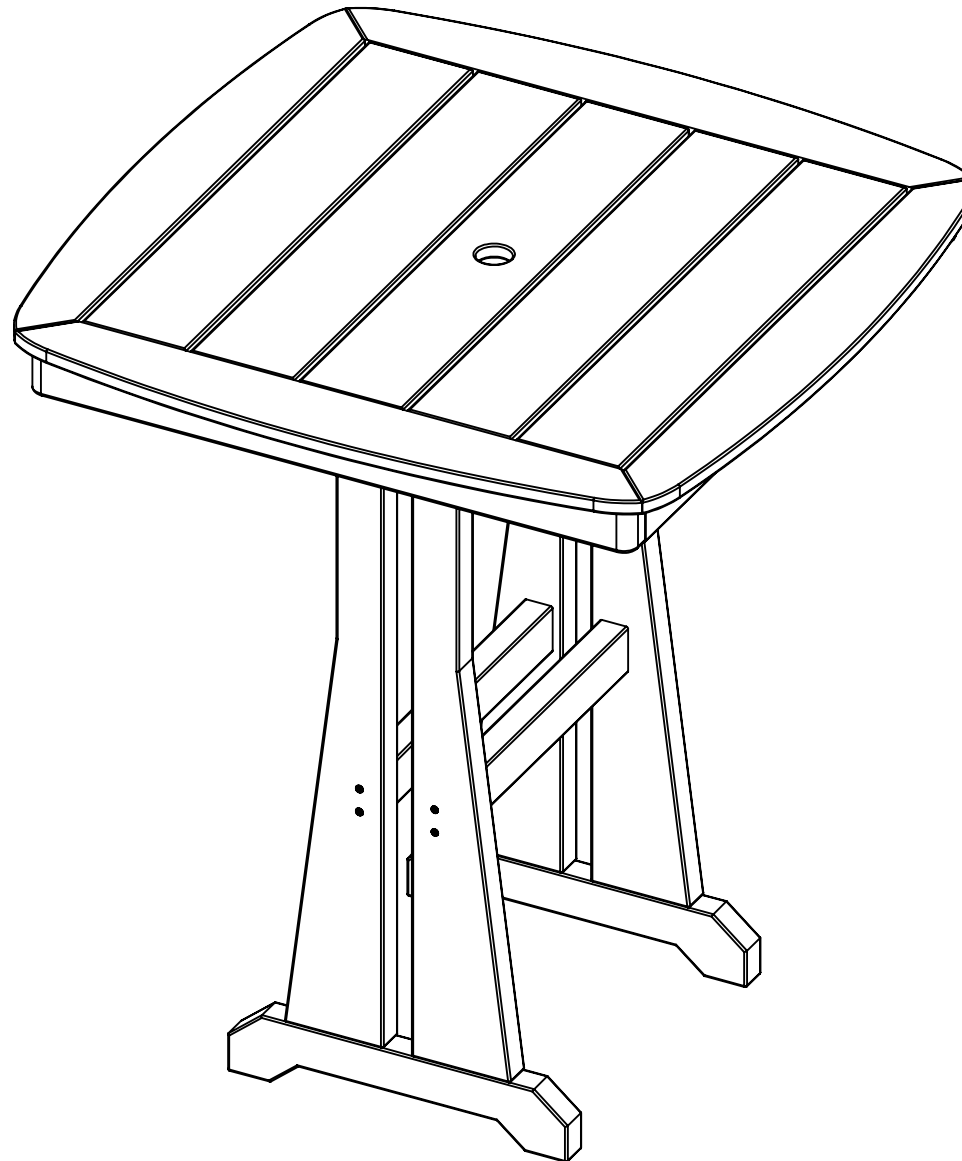
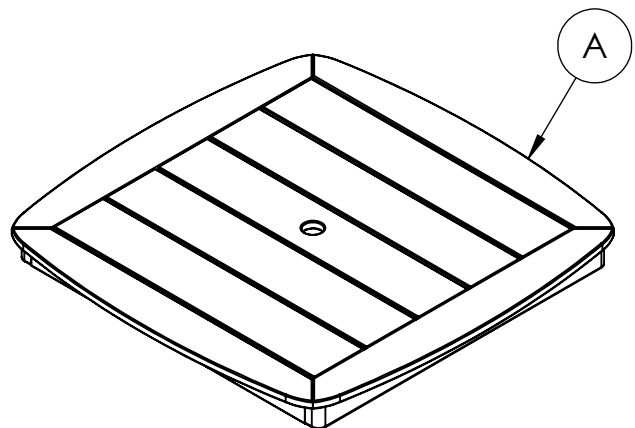
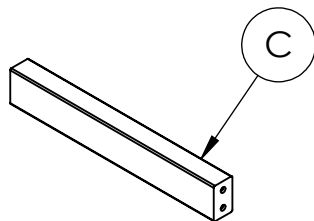

TABLE INSTRUCTIONS



1
Table Top Assembly



2
Cross Braces

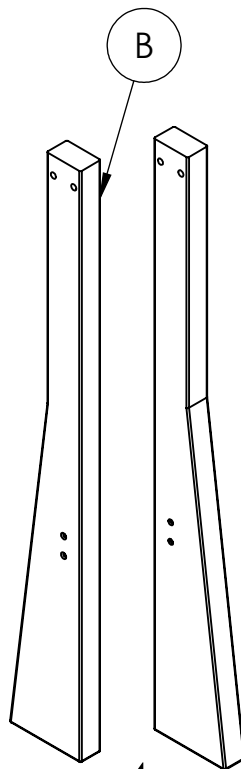

4
Table Legs

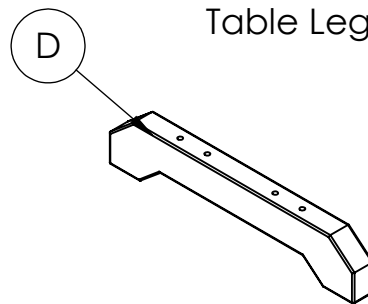

REQUIRED TOOLS (NOT INCLUDED)

- POWER DRILL
- #2 SQUARE DRIVE
- (2) 9/16 WRENCH OR SOCKET

**NOTE: IT IS IMPORTANT TO KEEP ALL
SCREWS LOOSE DURING ASSEMBLY
UNTIL ENTIRE TABLE IS ASSEMBLED**

HARDWARE

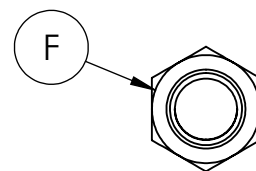

8
3/8" Hex Nuts

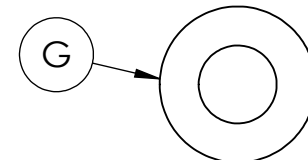

16
3/8" Flat Washer

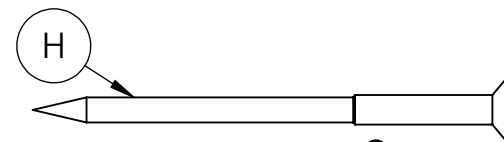

8
#10 x 2.5 Flat Head Screw

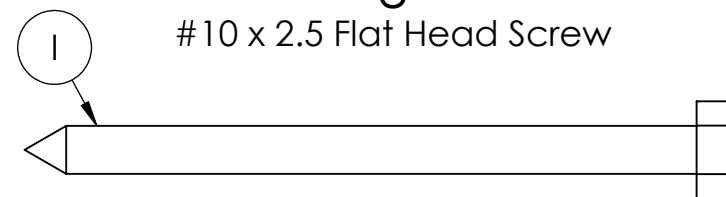

8
1/4" x 3.5" Hex Lag Screw

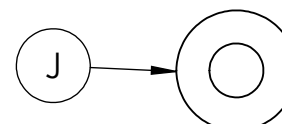

8
1/4" Flat Washer

**HARDWARE &
TOOLS REQUIRED
FOR ASSEMBLY**

2/5

TABLE INSTRUCTIONS

STEP 1

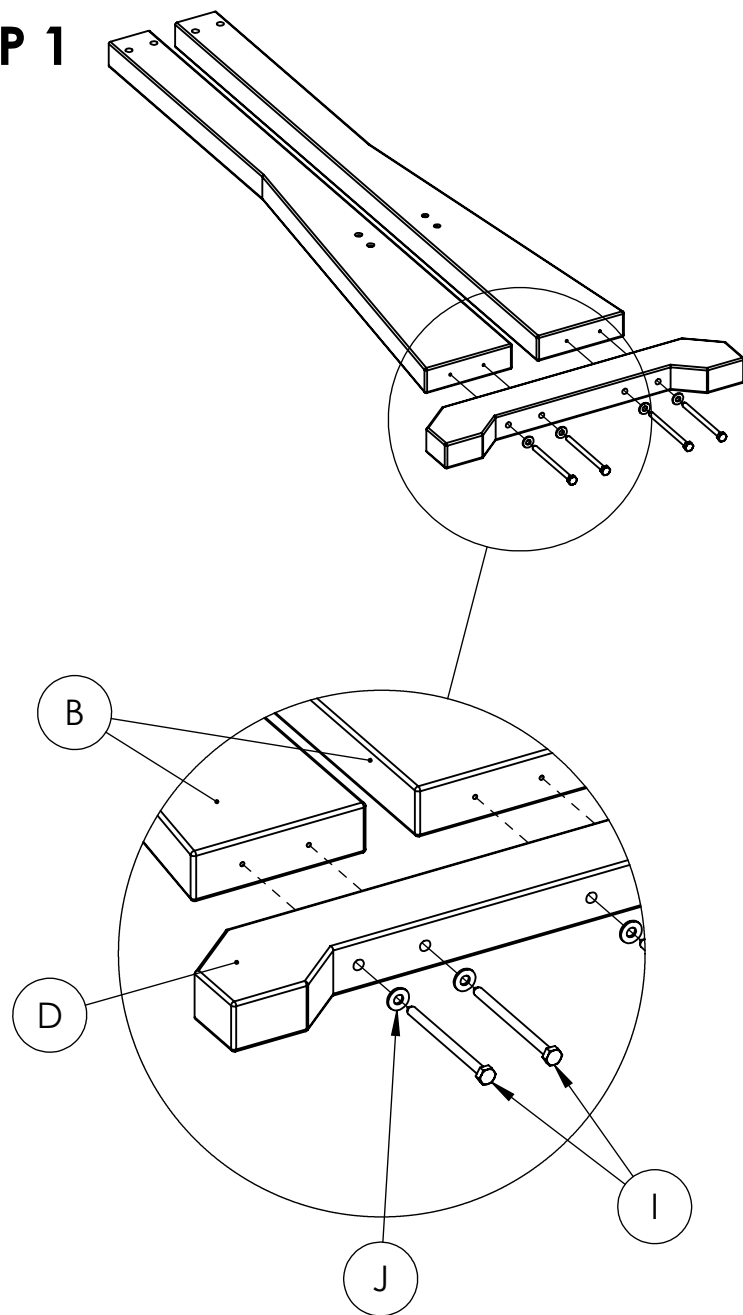

STEP 2

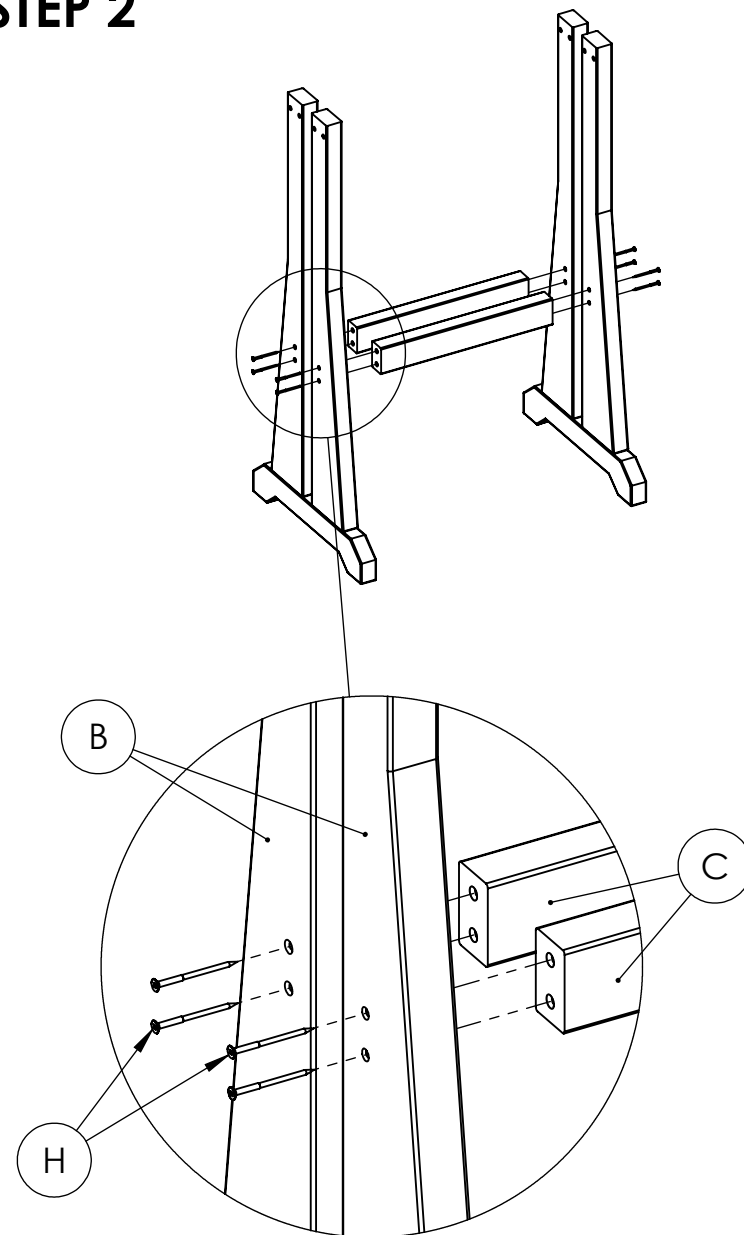

ASSEMBLY

3/5

TABLE INSTRUCTIONS

STEP 3

- Attach leg assembly with table upside down - **leave bolts loose.**
- Flip table right side up then fully tighten all bolts.

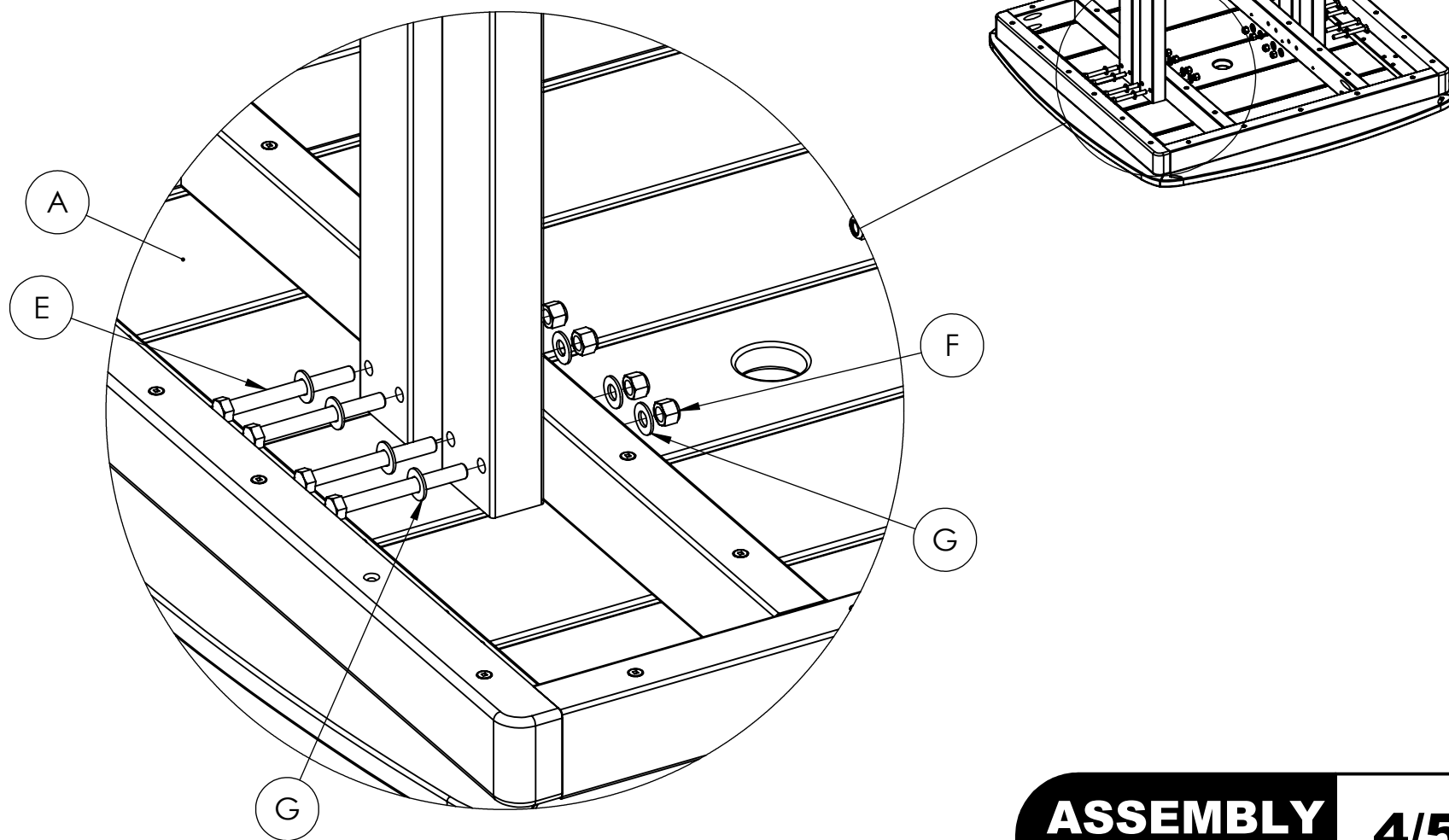
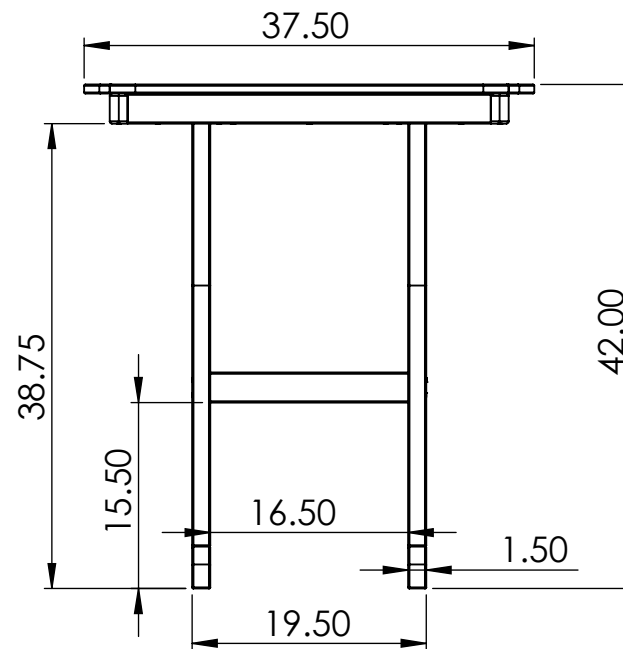
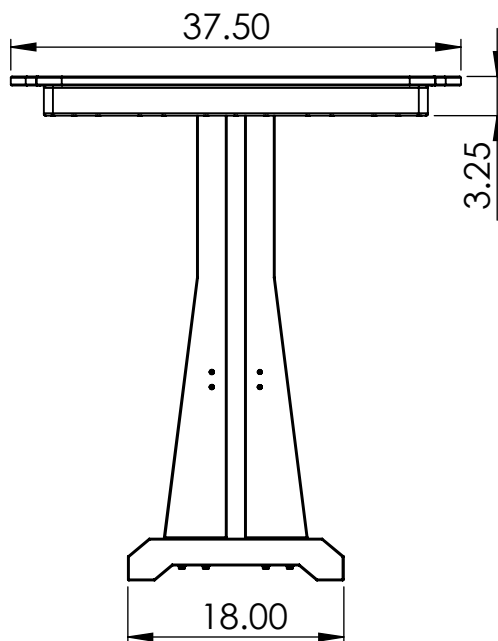
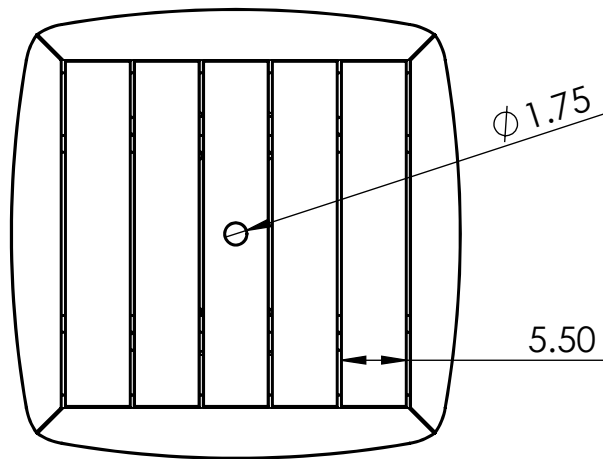

TABLE SPECIFICATIONS

CF1145 REV# 3
9-12-2022



CONSTRUCTION MATERIALS:
Recycled Plastic
HARDWARE:
Stainless Steel

ALL DIMENSIONS SHOWN IN INCHES