

BENCH INSTRUCTIONS BC1625

REV# 3
1-30-2017

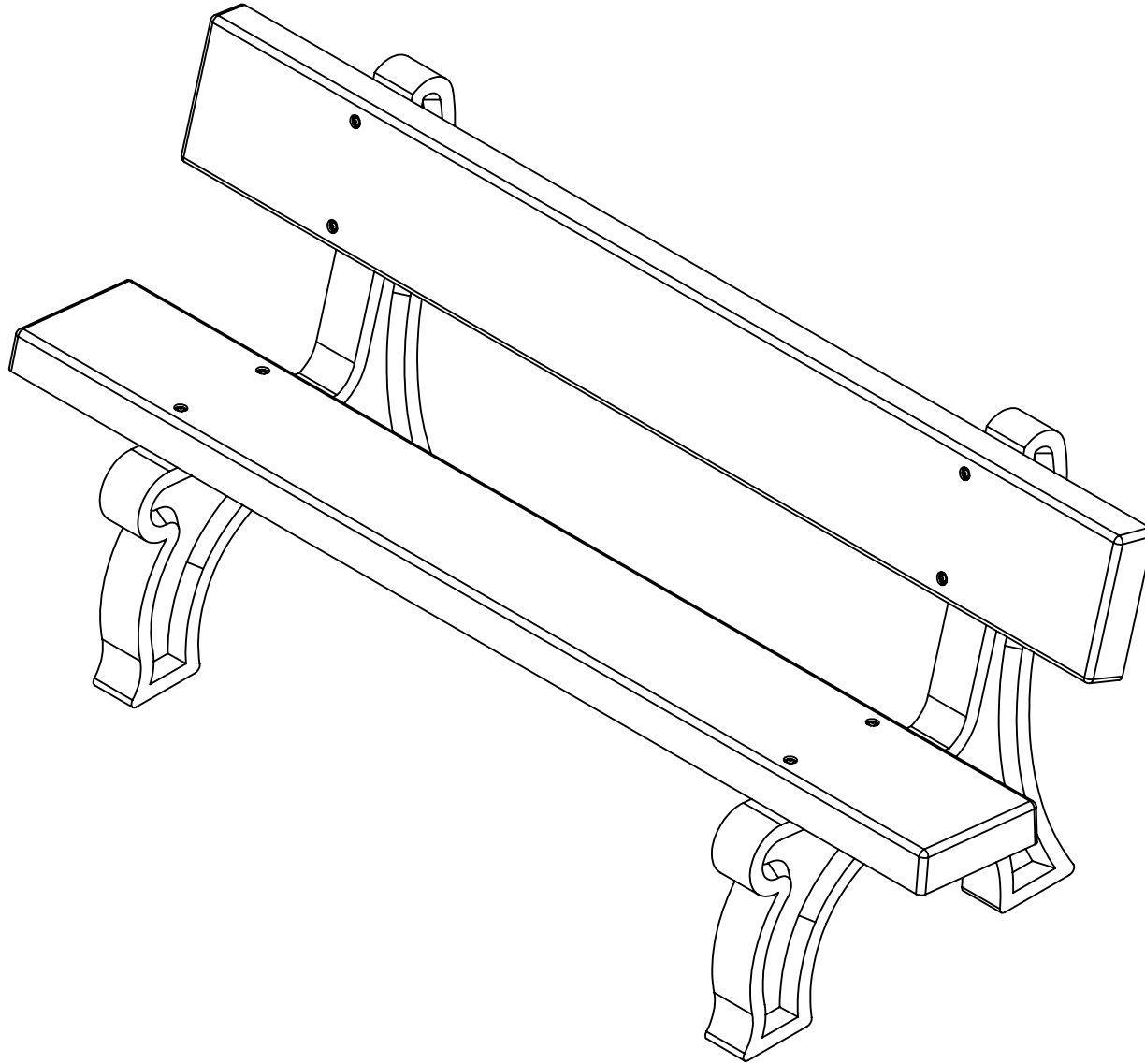

BENCH INSTRUCTIONS

BC1625

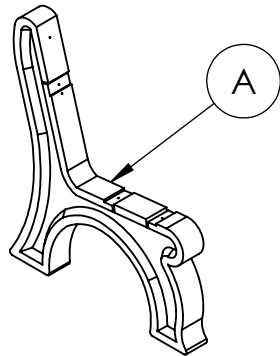

2
Plastic bench ends

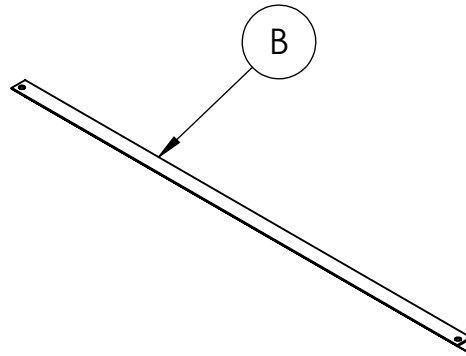

2
Seat support brace

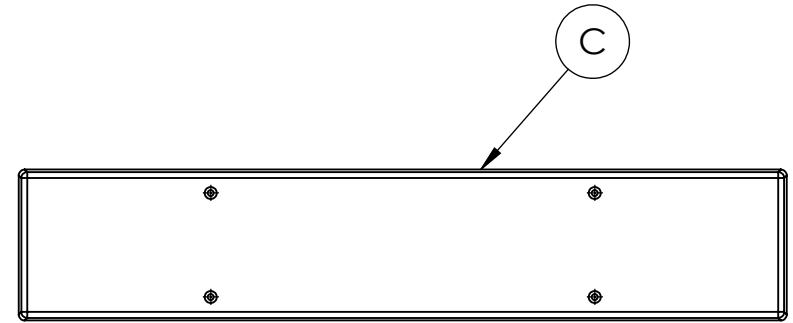

2
Plastic boards

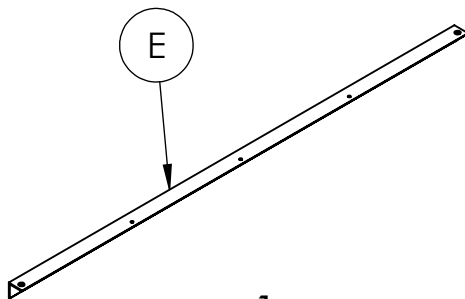

1
Back support brace

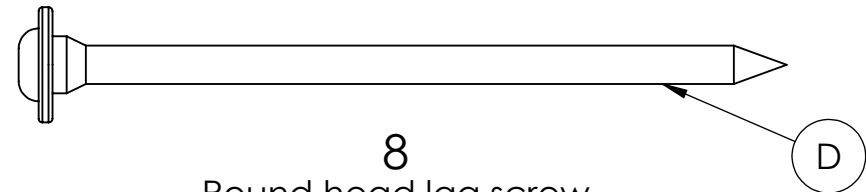

8
Round head lag screw

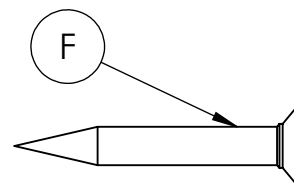

2
#12 X 1-1/2" Flat head screw

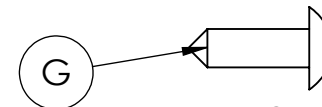

3
#12 X 3/4" Pan head screw

REQUIRED TOOLS (NOT INCLUDED)

- 1 - #3 PHILLIPS BIT
- 1 - POWER DRILL
- 1 - 1/8" DRILL BIT
- 1 - T30 TORX BIT IS INCLUDED

NOTE: IT IS IMPORTANT TO KEEP ALL BOLTS FINGER TIGHT DURING ASSEMBLY UNTIL ENTIRE UNIT IS ASSEMBLED

**HARDWARE &
TOOLS REQUIRED
FOR ASSEMBLY**

2/5

BENCH INSTRUCTIONS

BC1625

STEP 1

- Stand both plastic bench ends (A) upright
- Place the support braces (B) into the plastic bench ends (A) as shown
- Make sure to align the holes of the support braces with the hole in the plastic bench end

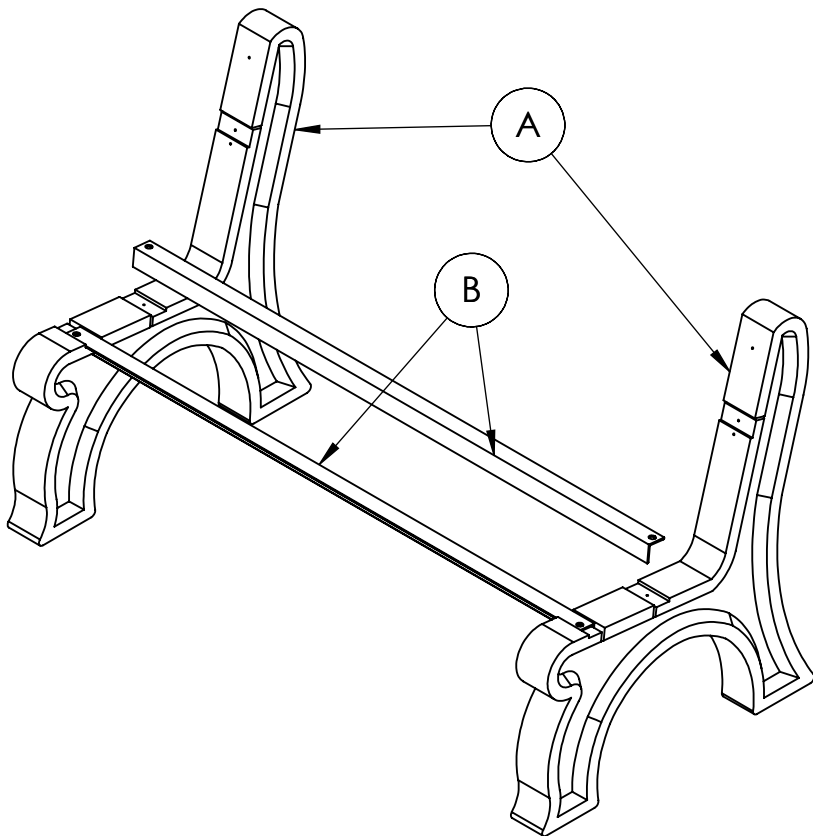

Step 2

- Place a plastic board (C) over the plastic end supports (A)
- Align the holes of the plastic board (C) with the holes in the support braces (B) and the predrilled holes in the plastic bench ends (A)
- Secure with (4) round head lag screws (D) using supplied T-30 torx bit

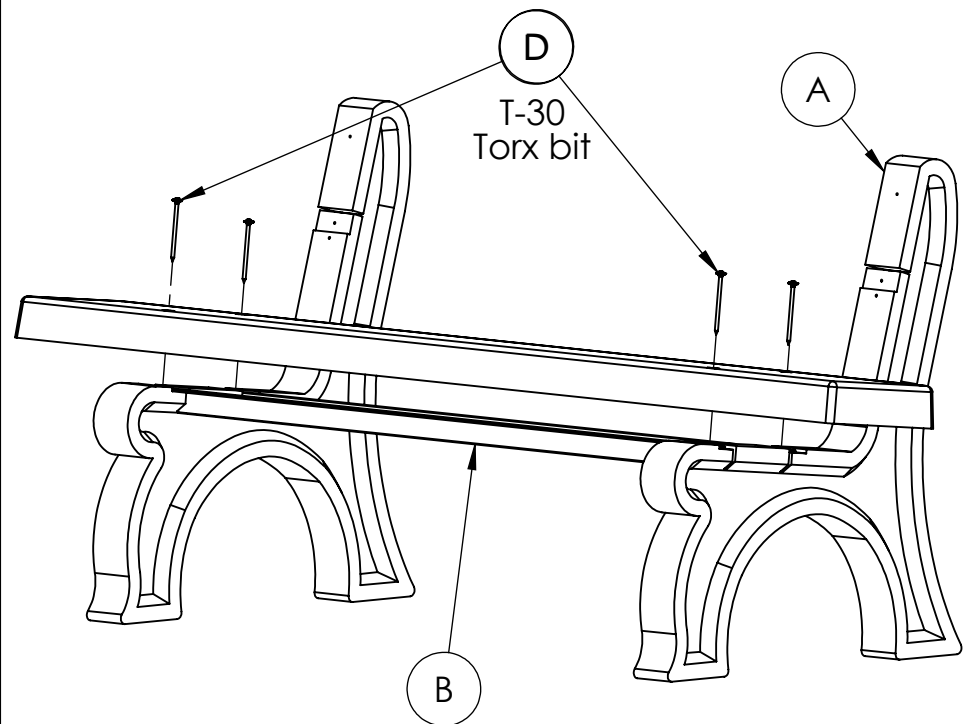

BENCH INSTRUCTIONS BC1625

Step 3

- Place the back support brace (E) in the slots on the plastic bench ends (A)
- Align the holes in the back support brace (B) with the predrilled holes in the plastic bench ends (A)
- Attach with (2) #12 x 1-1/2" flat head screws (F)

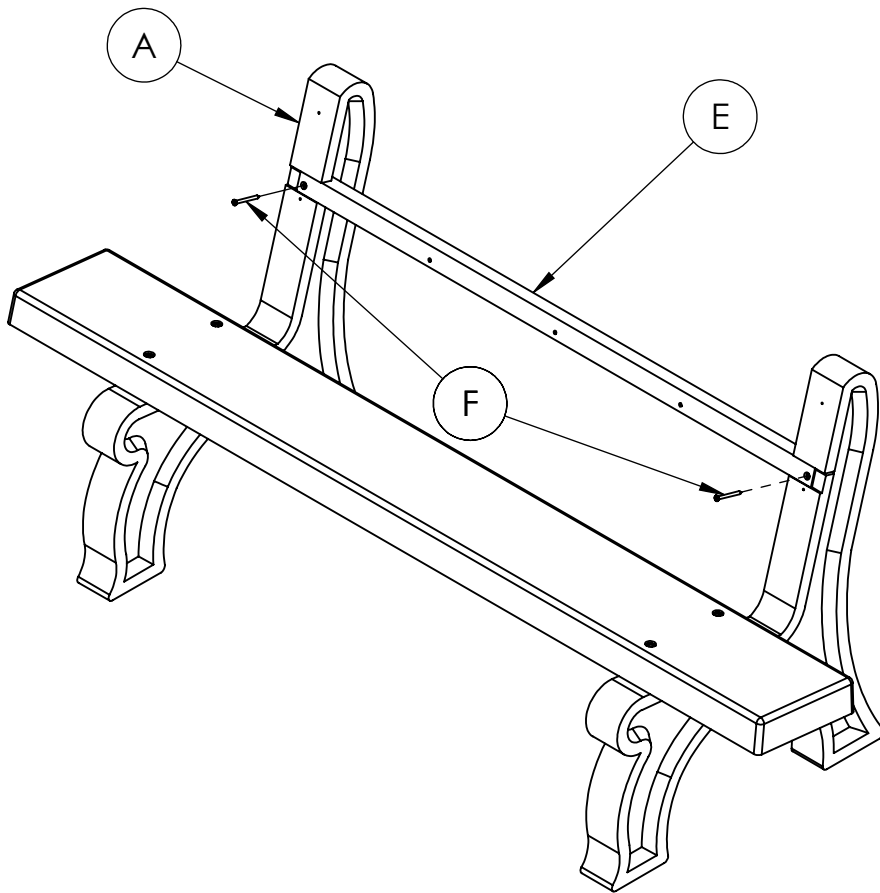

Step 4

- Hold the plastic board (C) against the back rest on the plastic bench ends (A)
- Align the predrilled holes in the plastic bench ends (A) with the holes in the plastic board (C)
- Secure with (4) round head lag screws (D)

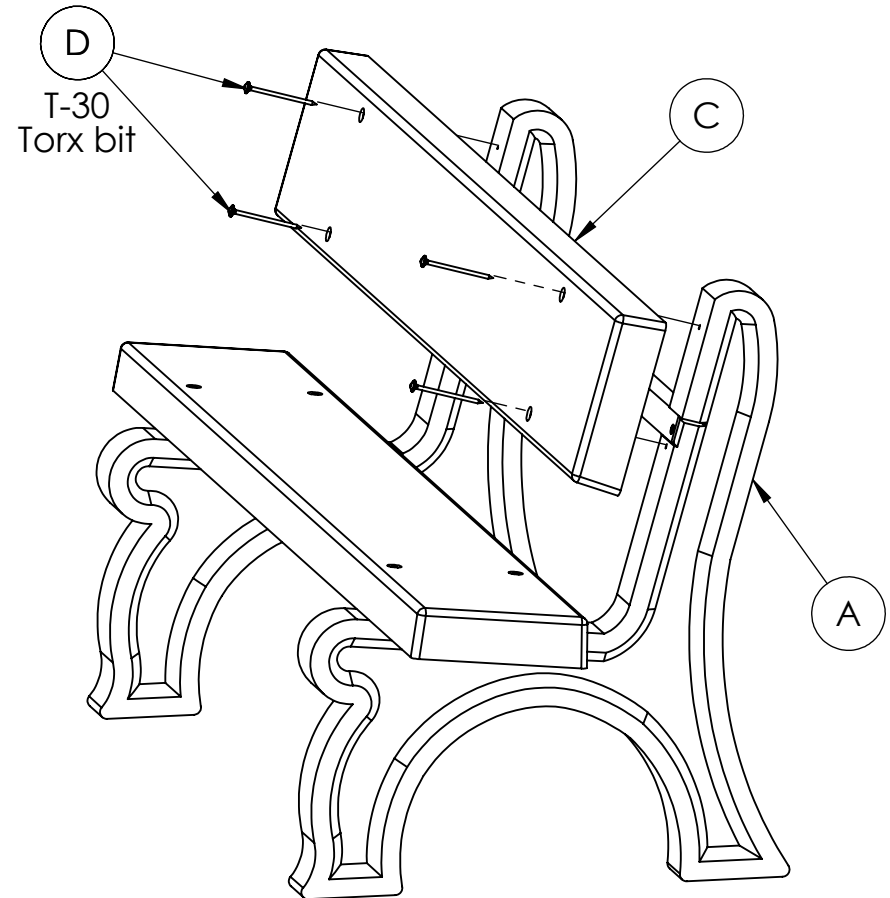

BENCH INSTRUCTIONS

BC1625

Step 5

- Locate the 3 holes in the back support brace (E)
- Drill an 1/8" hole in the cross section (X) of the plastic board (C) at each hole location on the back support brace
- Secure with (3) #12 x 3/4" pan head screws (G)

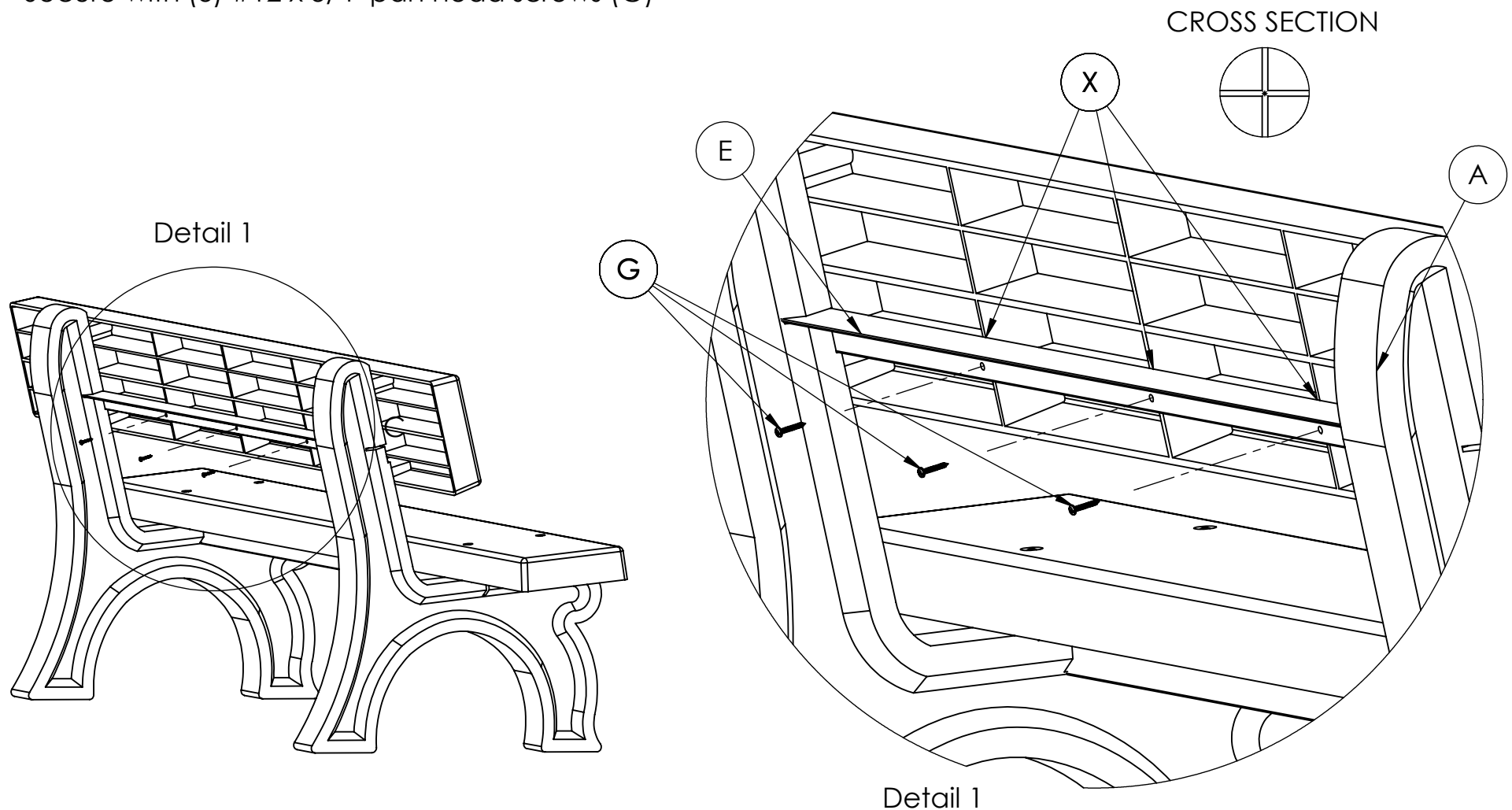

BENCH SPECIFICATIONS BC1625

REV# 3
1-30-2017

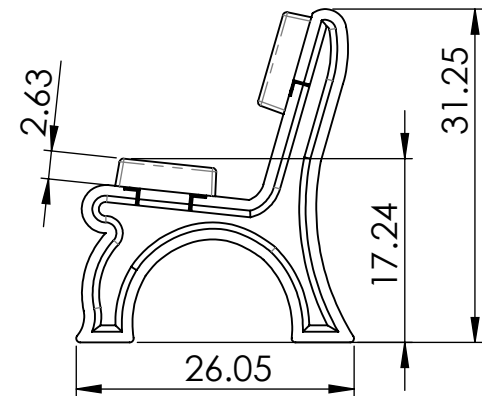
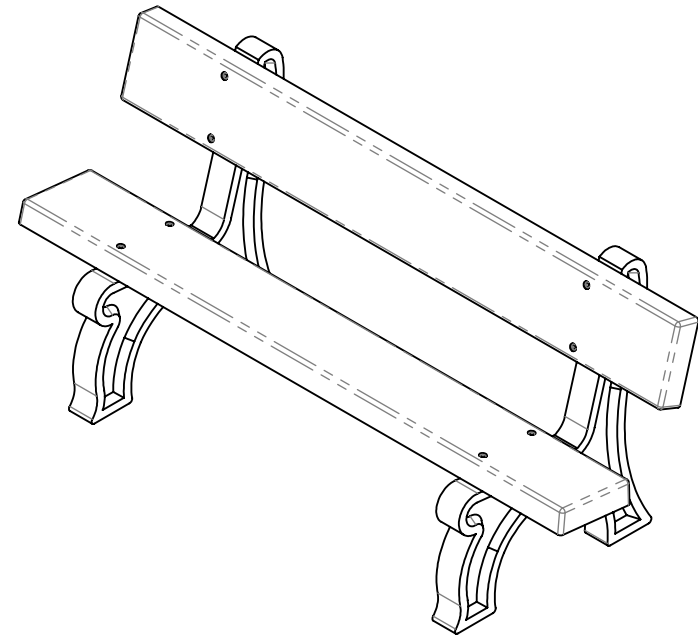
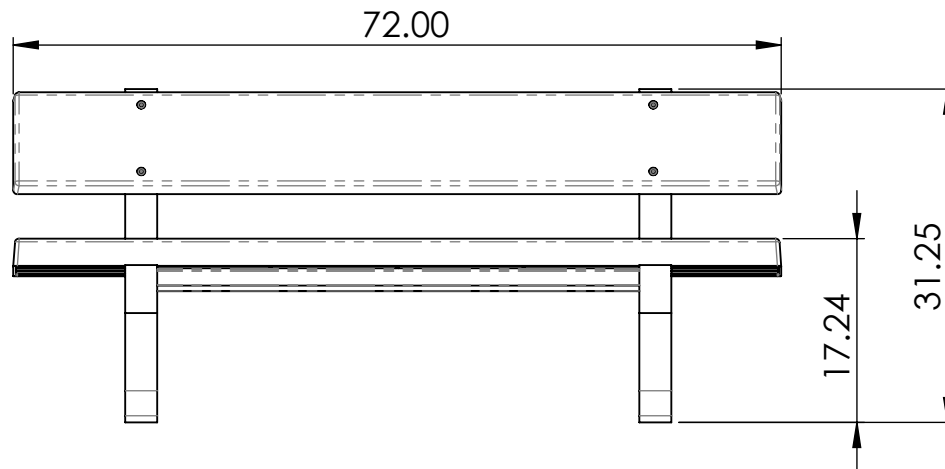
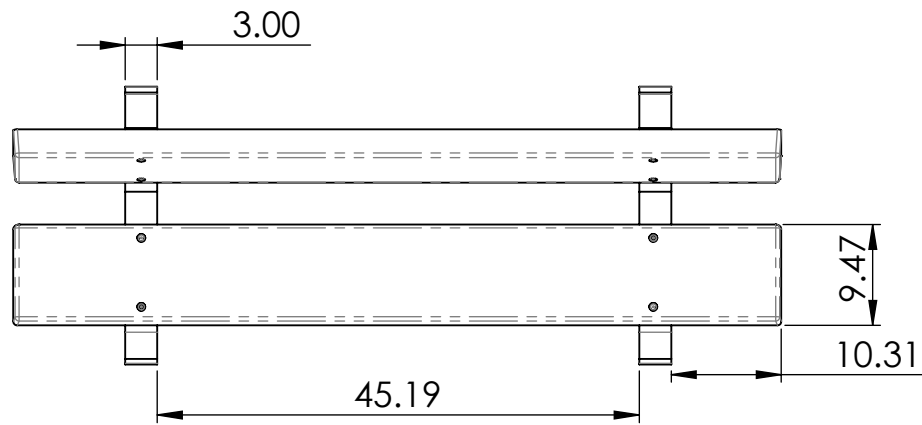

ALL DIMENSIONS SHOWN IN INCHES